

A.1 A.2 A.3 A.4 A.5 A.6 A.7 A.8 A.9 A.10 A.11 A.12 A.13 A.14 A.15 A.16

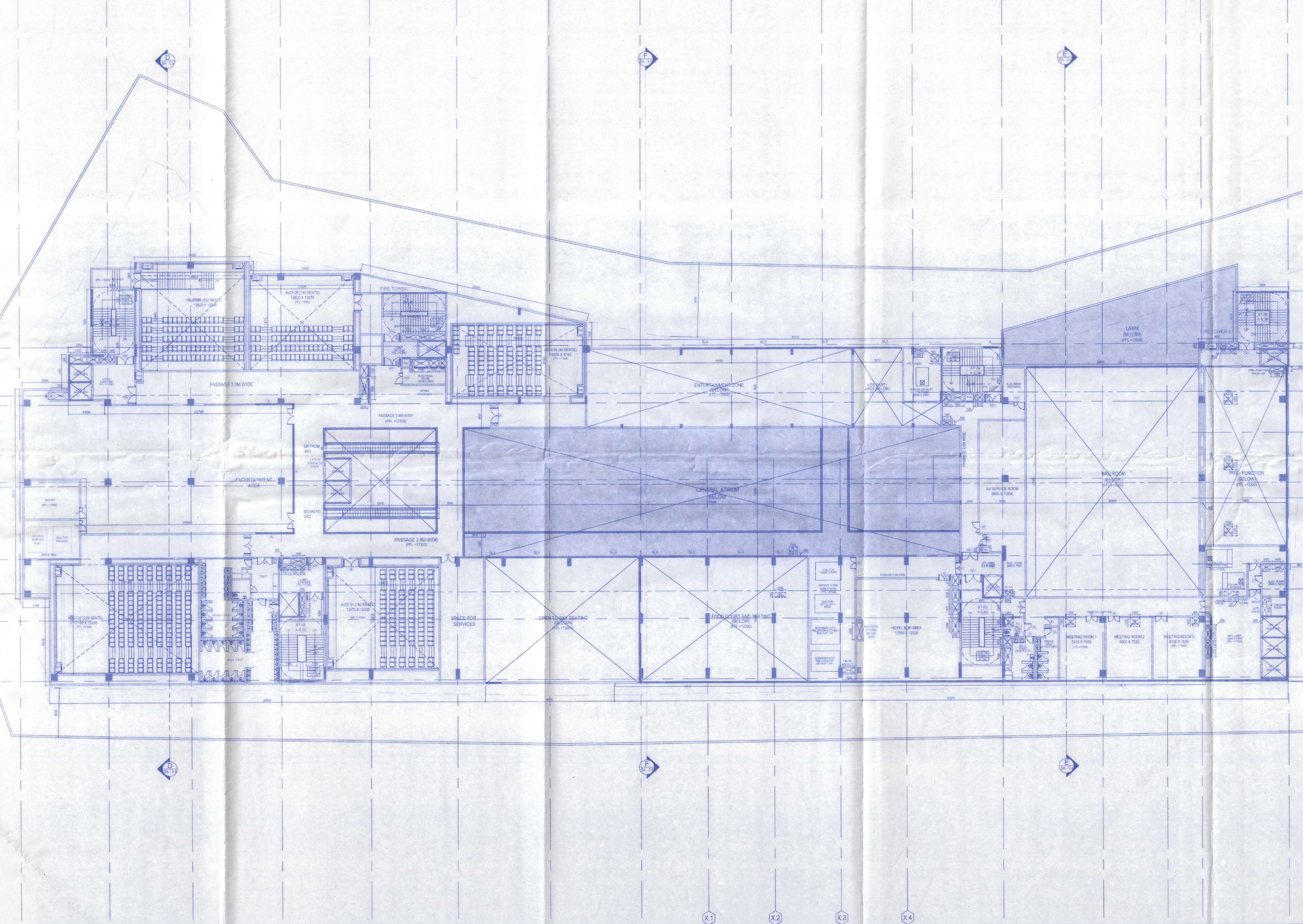

SHAFT LEGENDS	
LV	LOW VOLTAGE CABLE SHAFT
ELEC.	ELECTRICAL SHAFT
PL	PLUMBING SHAFT
LLPS	LIFT LOBBY PRESSURISATION SHAFT
FHC	FIRE HOSE CABINET
CWS/R	COLD WATER SUPPLY/RETURN
CHWS/R	CHILLED WATER SUPPLY/RETURN
COR. (FR)	CORRIDOR FRESH AIR
COR. (EX)	CORRIDOR EXHAUST
SPL. KIT. (EX)	SPECIALITY KITCHEN EXHAUST
TOI. (EX)	TOILET EXHAUST
ST (PR)	STAIRCASE PRESSURISATION SHAFT
PAN (EX)	PANTRY EXHAUST
STP (EX)	STP EXHAUST
DIS. KIT. (EX)	DISPLAY KITCHEN EXHAUST
KIT. TFA	KITCHEN TREATED FRESH AIR
KITCHEN (S/R)	KITCHEN (SUPPLY/RETURN AIR)
HOTEL BOH (EX)	HOTEL BOH EXHAUST
KIT. (EX)	KITCHEN EXHAUST

- PROJECT CODE: 196-2021
- This Drawing and Design is the Property of the Designer. No Portion may be used or Reproduced without the Written Permission.
 - All Dimensions are to be Verified onsite by the Contractor. Any Discrepancies are to be Reported to the Designer Immediately.
 - This Drawing is to be Read in Conjunction with the Designer's Specifications, Conditions of Contract and Relevant Consultant Drawings.
 - Drawings Not Showing the Latest Revisions are to be Cancelled.
 - All Dimensions are to be Read Not Starting.
 - All Indicated Levels are Finished Levels unless Noted Otherwise.
 - Architect is not responsible for any deviation in areas (SUIT, Structural, marking etc.).
 - Any and All Deviations from Municipal Drawings is understood to be made at risk of cost incurred with your information provided to the client by architect about legal implications. Architect in no way whatsoever can be held responsible for such deviations.

DOOR WINDOW SCHEDULE	
TYPE	NO. OF
DOOR	1200
WINDOW	2500
GLASS	1500
ALUMINIUM	1000
STEEL	800
WOOD	300
OTHER	200

AREA STATEMENT
TOTAL F.A.R. ON FOURTH FLOOR: 3116.56 SQM.

SPECIAL NOTE:
THE BUILDING IS FULLY MECHANICALLY VENTILATED.

CLIENT: SKA DEVELOPERS REPRESENTED BY: SRI SURESH KUMAR AGARWAL
PROJECT: HOTEL METAL SHOPPING MALL (PHASE 1) AT LITTOROYAN TOWNSHIP, N.31, SRI LANKA.
ARCHITECT: SKA DEVELOPERS
PARTNER: SRI SURESH KUMAR AGARWAL
SIGNATURE OF CLIENT

ARCHITECT: *[Signature]*

STRUCTURE: *[Signature]*

SIGNATURE OF STRUCTURE ENGINEER: *[Signature]*

SANJIV J. PAREKH
M.E. (STRUCT.), M.E. (CONST. ENG.)
P. C. E., F.I.E. (E-018202-4)
F. S. E. (NO. 1041) K.M.C.
STRUC. ENGR-17-S.M.C.

PROJECT: PLAN SHOWING (BASEMENT-1-BASEMENT-2-BASEMENT-3 -GROUND-FLOOR) STORED MIXED USED OFFICE HOTEL METAL SHOPPING MALL (PHASE 1) BUILDING AT LITTOROYAN TOWNSHIP, N.31, SRI LANKA.

DRAWING TITLE: SA-1-08 - FOURTH FLOOR PLAN

REVISIONS		
REV. NO.	DATE	REMARKS

PROJECT STARTED	SCALE: 1:200	N
CHECKED: ADITYA	DEALT: PRASHANT	
DRAWING NO.		R2
		22 NOV 2022

May be Submitted
 Registered Architect
 Shrihari Mahalingam Parthasarathy
 Bangalore, Dist. Dharwad

The construction of the Building shall be supervised by the Licensed Engineer/Architect signing the plan application. Unless otherwise approved by the Authority the permission shall remain valid for a period of TWO YEARS. Permission Granted/Permission granted subject to the condition as noted in the ORDER Building plans also to be approved by the Maligara Panchayat Samity, before the proposed construction undertaken

DATE 10/3/2023
 EXECUTIVE OFFICER
 Maligara Panchayat Samity
 P.O. Kadamtala, Dist. Dharwad

APPROVE
 Sub Assistant Engineer (B.P.C)
 Maligara Development Block
 P.O. Kadamtala, Dt. Dharwad



NO. OF FLOORS	1
NO. OF ROOMS	12
NO. OF STAIRS	1
NO. OF LIFT	0
NO. OF WATER TANKS	1
NO. OF W.C.	12
NO. OF BATHS	12
NO. OF KITCHENS	12
NO. OF STORES	12
NO. OF OFFICES	12
NO. OF BED ROOMS	12
NO. OF HALLS	12
NO. OF CORRIDORS	12
NO. OF ENTRANCES	12
NO. OF EXITS	12
NO. OF WINDOWS	12
NO. OF DOORS	12
NO. OF ROOFS	12
NO. OF WALLS	12
NO. OF FLOORS	12
NO. OF ROOMS	12
NO. OF STAIRS	12
NO. OF LIFT	12
NO. OF WATER TANKS	12
NO. OF W.C.	12
NO. OF BATHS	12
NO. OF KITCHENS	12
NO. OF STORES	12
NO. OF OFFICES	12
NO. OF BED ROOMS	12
NO. OF HALLS	12
NO. OF CORRIDORS	12
NO. OF ENTRANCES	12
NO. OF EXITS	12
NO. OF WINDOWS	12
NO. OF DOORS	12
NO. OF ROOFS	12
NO. OF WALLS	12

SKY DEVELOPERS
 Bangalore

11/00/2023/001/23/ENG
 P. G. E. B. E. D. S. A. S. S. O. C. Y.
 MALIGARA DEVELOPMENT BLOCK
 P. O. KADAMTALA, DIST. DHARWAD

MAJAPUR HTRUD - 88 - 142

NO. OF FLOORS	1
NO. OF ROOMS	12
NO. OF STAIRS	1
NO. OF LIFT	0
NO. OF WATER TANKS	1
NO. OF W.C.	12
NO. OF BATHS	12
NO. OF KITCHENS	12
NO. OF STORES	12
NO. OF OFFICES	12
NO. OF BED ROOMS	12
NO. OF HALLS	12
NO. OF CORRIDORS	12
NO. OF ENTRANCES	12
NO. OF EXITS	12
NO. OF WINDOWS	12
NO. OF DOORS	12
NO. OF ROOFS	12
NO. OF WALLS	12